

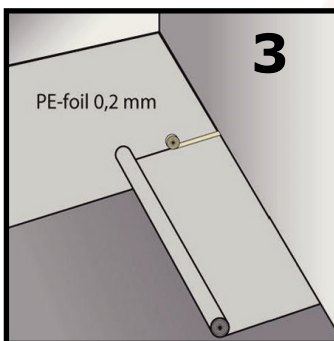

1. Before starting, ensure the subfloor is level and has the climatic conditions suitable for the installation.
2. Vacuum the sub-flooring before commencing installation and ensure work area is clean and free from obstructions.

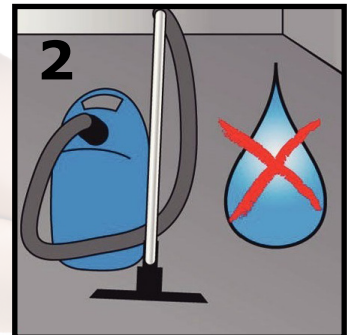

3. We recommend laying the flooring lengthwise to the main source of light, to take into account the lights' angle of incidence. The laying of the floor must be considered before beginning the installation, to avoid boards being short or narrow against the wall.



+44 (0) 1480 494540



www.lemarkfloors.com



info@lemark.co.uk



/LeMarkFloors



@LeMarkFloors

4. Measure room before commencing. A 0.20mm thick layer of plastic, taped at joins, is laid on the concrete sub-flooring. Lay the perimeter strips, 15mm x 100mm, along the wall, in the direction the flooring is to be laid.

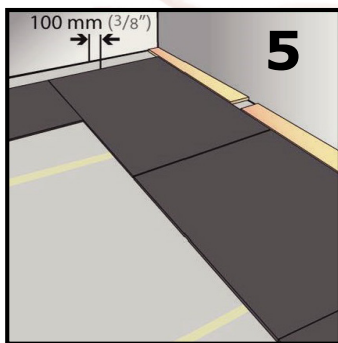
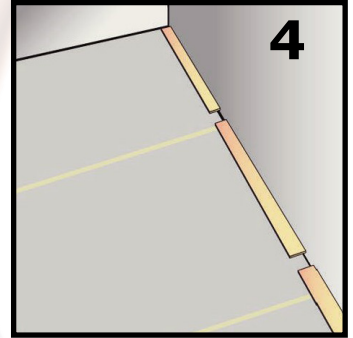

5. Lay the Meadow™ Sprung underlay 2000mm x 1500mm x 8mm against the row of supporting boards. The underlay must not be laid less than 100mm from the side walls.

6. Place the first board with the tongue facing the wall and the groove facing outwards. There must be a minimum clearance along the wall of 8-10mm (1.5mm per metre room width). The next board is laid at an angle (approx. 30°) against the end join and pressed down. Continue this way until the first row is laid.

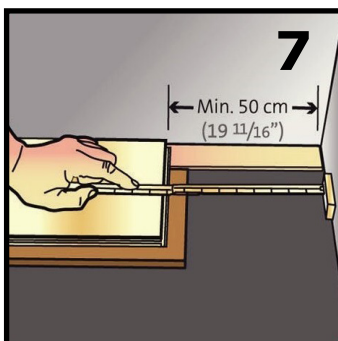
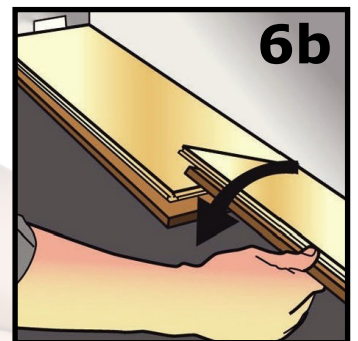
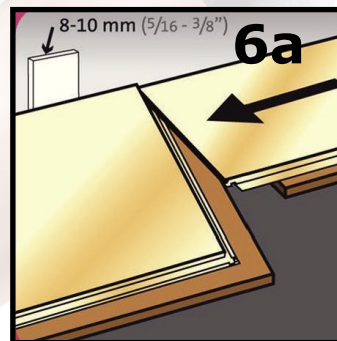

7. Begin the second row with the off-cut board from the first row, which must be a minimum of 500mm.

8. Cut support blocks 15mm x 100mm x 70mm and place them under the Meadow™ Sprung boards at the ends of each row.

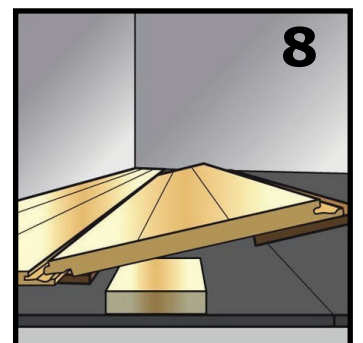

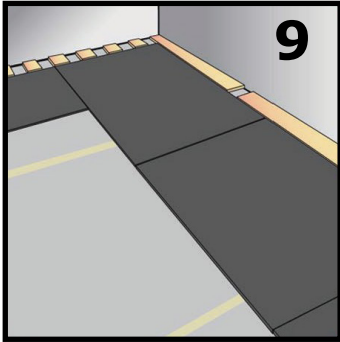

9. The Meadow™ Sprung mats are gradually laid as the floor is installed. The off-cut from the first row is used to start the next row, this ensures that the mats are laid randomly and remain in place.

10. Use a light knock with a tapping block (e.g. 100mm x 100mm or similar) against the lower edge of the flooring while pressing down the row of boards against the underlay such that the boards slip into place.

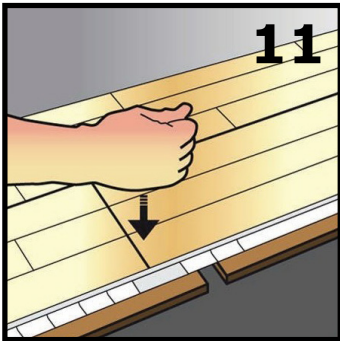
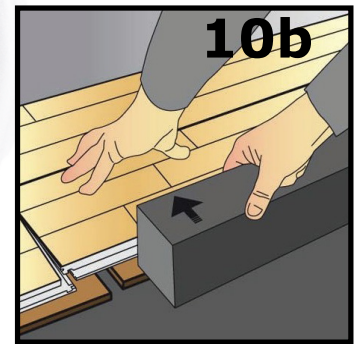
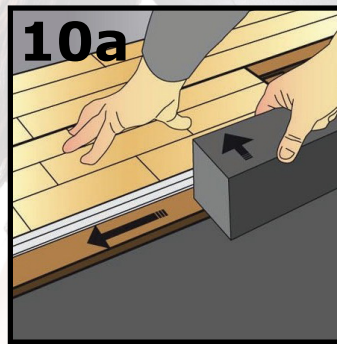

11. By pressing the board at the end, the tongue will yield and "lock" the boards together.

12. Continue hovering the next row, using the off-cut from the previous row. Ensure that there is a minimum overlap of 400mm between the boards.

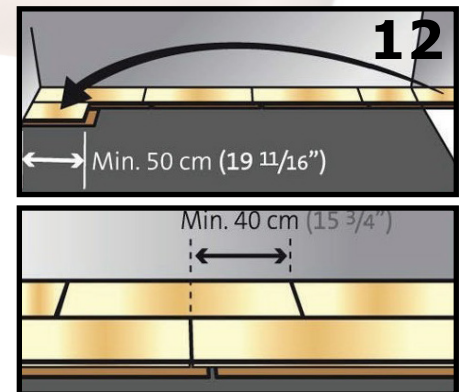

+44 (0) 1480 494540



www.lemarkfloors.com



info@lemark.co.uk



/LeMarkFloors



@LeMarkFloors

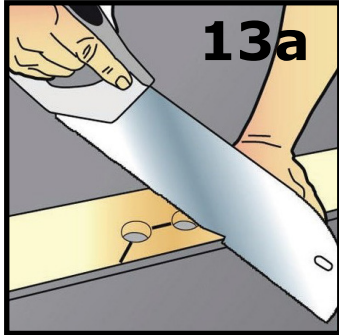

13a

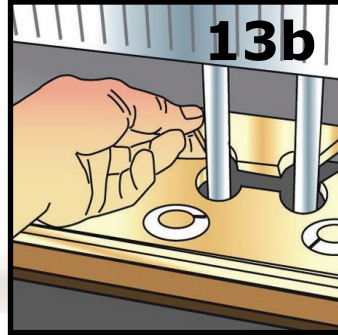

13b

13. Apertures for piping etc. must be as spacious as possible so as to allow for free movement of the floor. The apertures are then covered with pipe-collars.

14. After flooring is installed it is important to ensure that the room remains temperate with the relative humidity between 30 and 60%. Clean floor using a dry dust mop or vacuum cleaner. If floor needs to be washed it's good to keep the use of water to a minimum.

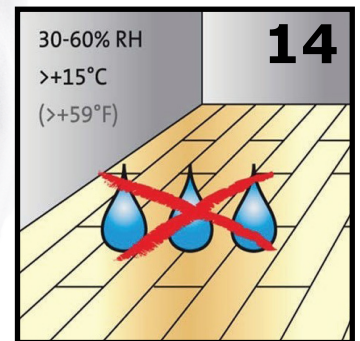

14

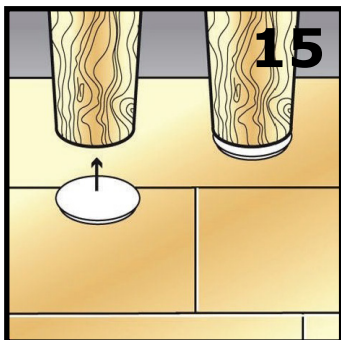

15

15. Do not allow water to dry on the surface of the flooring. Le Mark recommend the use of floor protectors under furniture and chair legs to protect the surface of the flooring.

Removal/ Dismantling

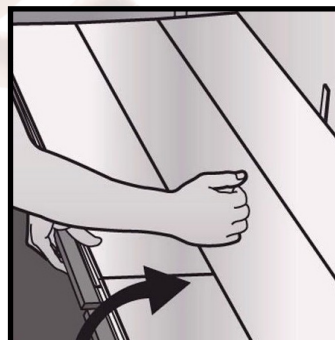

Always store the hardwood flooring in dry conditions and do not open the cartons until just before use. Our quality controllers have sorted and graded the flooring. Should there be any doubt concerning grading and/or visual defects, it is important that claims be made prior to the flooring being installed. For more information on Le Mark products, please visit www.lemarkfloors.co.uk



+44 (0) 1480 494540



www.lemarkfloors.com



info@lemark.co.uk



/LeMarkFloors



@LeMarkFloors